

PAX S300 QUICKSTART GUIDE

What's in the box:

S300 Device
& Stylus



AC Power Adapter

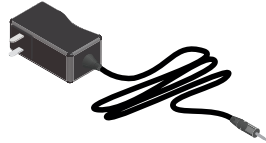

3 Port Dongle Connector

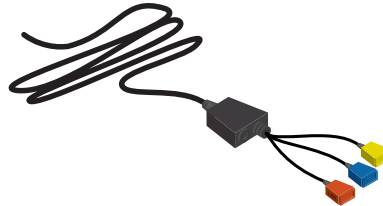

Ethernet Cable



How to connect the S300 to your system:

Step 1 - Connect one end of the Ethernet cable into the red port marked LAN.

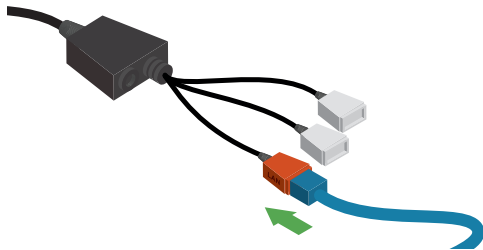

Step 2 - Connect the other end of your Ethernet cable into the port labeled LAN on your internet source (ie. switch or router).

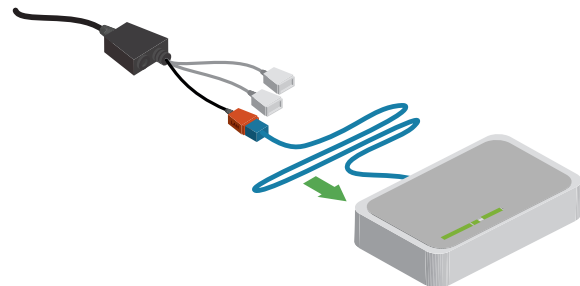

Step 3 - Connect the AC power adapter to the small round power port to the left of the 3 port dongle.

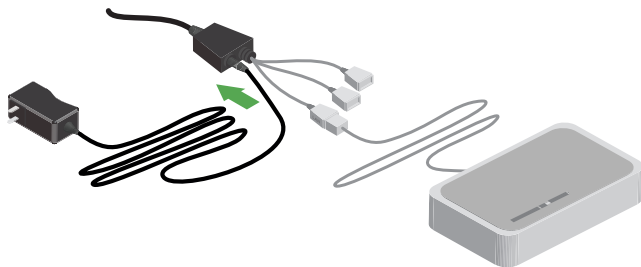

Step 4 - Plug in the power adapter to any available electrical outlet.

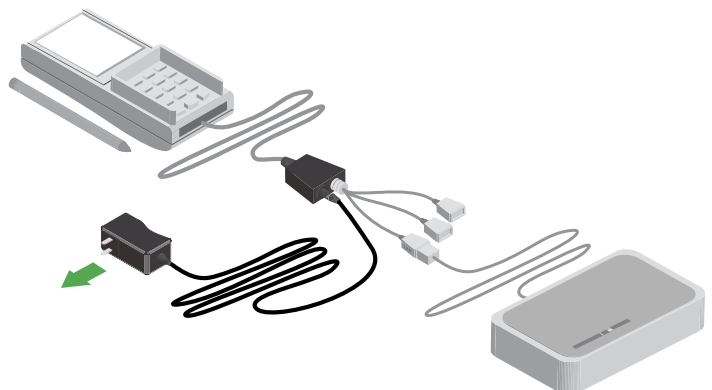

Congratulations! Now that your device is connected, you're ready to call **Gravity Payments** to complete your device setup at **(800) 989-2135**.

If you still need help connecting your device, call **Gravity Payments Technical Support** at **(800) 989-2135**.